

TOP VIEW

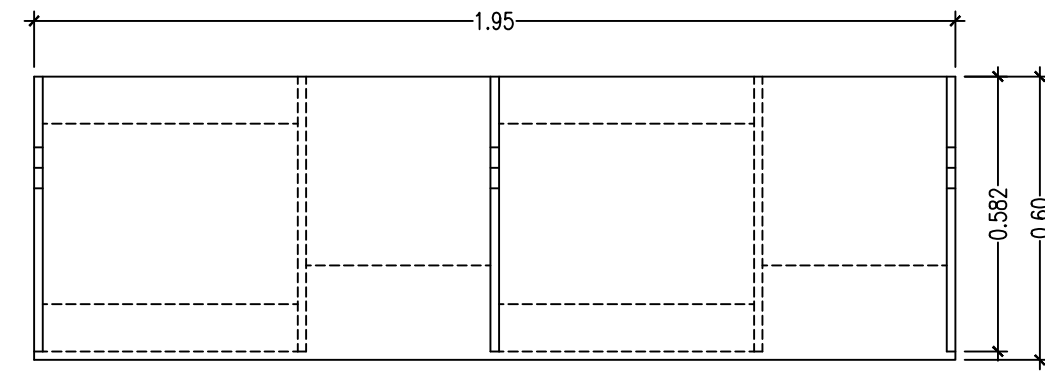

FRONT VIEW

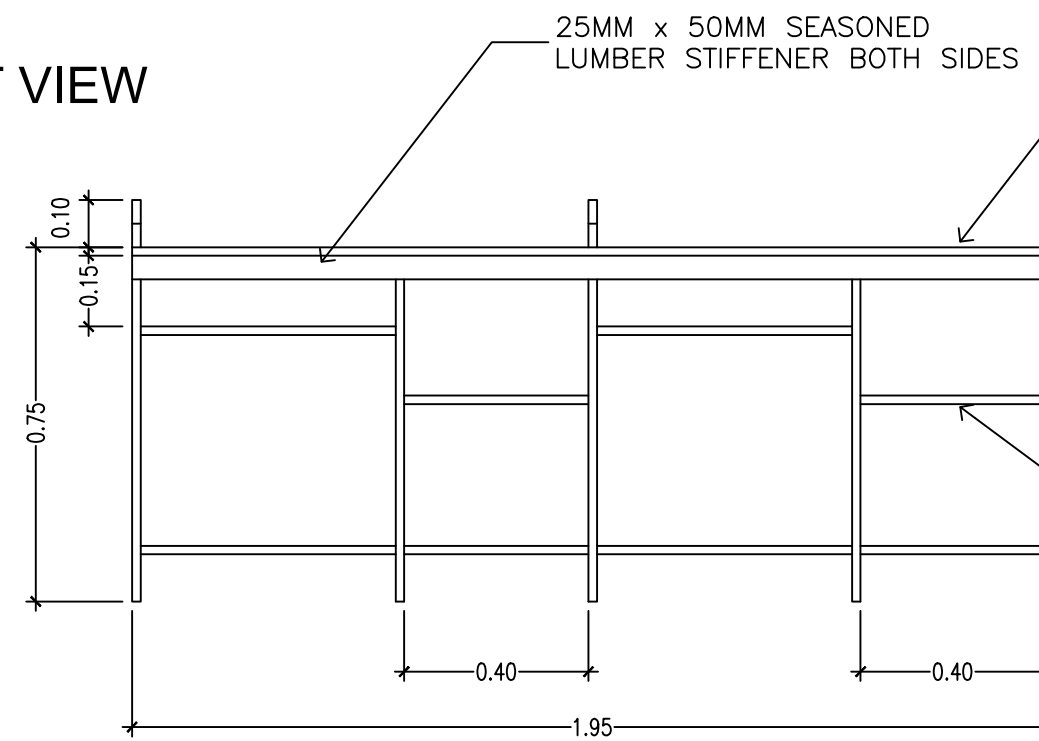

18MM THK. LAMINATED MARINE PLYWOOD TABLE TOP; W/ APPROVED FINISH

18MM THK. LAMINATED MARINE PLYWOOD DRAWER W/ 6MM THK. MARINE PLYWOOD BASE; FITTED W/ 400MM DRAWER SLIDE, 150MM STAINLESS STEEL DRAWER HANDLE, 32MM STAINLESS STEEL PADLOCK LATCH

18MM THK. LAMINATED MARINE PLYWOOD OPEN SIDE SHELVES W/ 6MM THK MARINE PLYWOOD BACK COVER; W/ APPROVED FINISH

SIDE VIEW

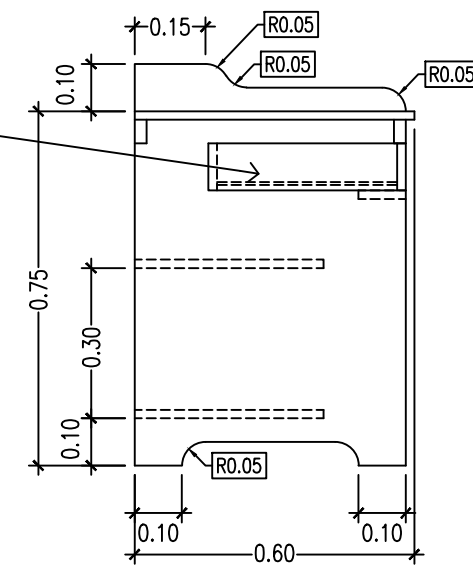

1 FABRICATION OF STUDY TABLE
DRAWN NOT TO SCALE

TOP VIEW

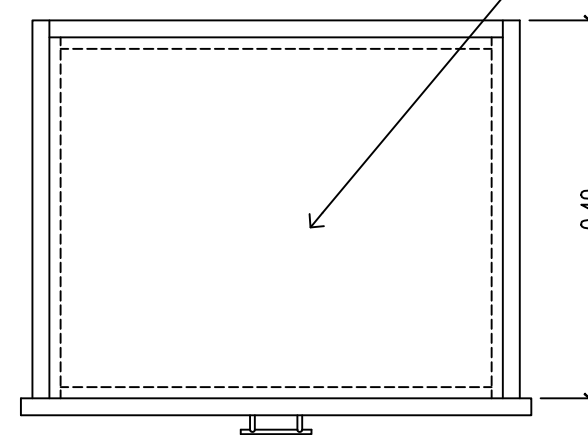

18MM THK. LAMINATED MARINE PLYWOOD DRAWER W/ 6MM THK. MARINE PLYWOOD BASE; FITTED W/ 400MM HEAVY DUTY DRAWER SLIDE, 150MM STAINLESS STEEL DRAWER HANDLE, 32MM STAINLESS STEEL PADLOCK LATCH

FRONT VIEW

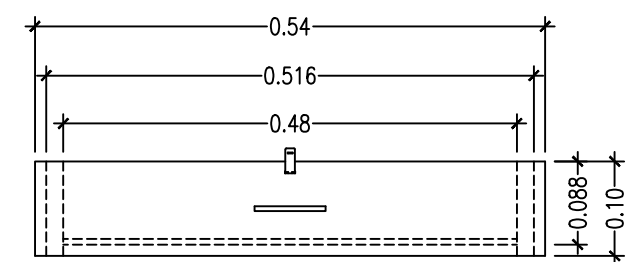

SIDE VIEW

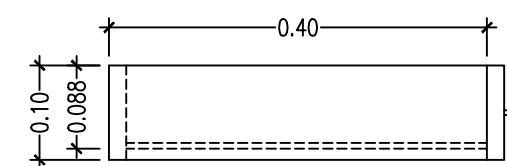

2 DETAILS OF TABLE DRAWER
DRAWN NOT TO SCALE

FOR BIDDING

PROFESSIONAL	PROJECT/LOCATION	OWNER	APPROVED BY:	REVISION	SHEET CONTENTS	SCALE AS_SHOWN	SHEET
ARCHITECT/ENGINEER	REHABILITATION OF SCHOOL BUILDINGS	Department of Science and Technology PHILIPPINE SCIENCE HIGH SCHOOL MAIN CAMPUS	LAWRENCE V. MADRIAGA, PhD Director, PSHS – MAIN CAMPUS	DATE 20190510	STUDY TABLE DESIGN FOR GRHM		5
PRC NO.:	PTR:						A
VALID UNTIL:	DATE/PLACE:						
	Agham Road, Diliman, Quezon City				DRAWN CHECKED	DESIGNED DATE 10MAY2019	THESE DRAWINGS ARE INSTRUMENTS OF PROFESSIONAL ARCHITECTURAL SERVICE AND ARE NOT TO BE REPRODUCED OR USED EXCEPT BY WRITTEN AGREEMENT WITH THE ARCHITECT. (R.A. 9286)