

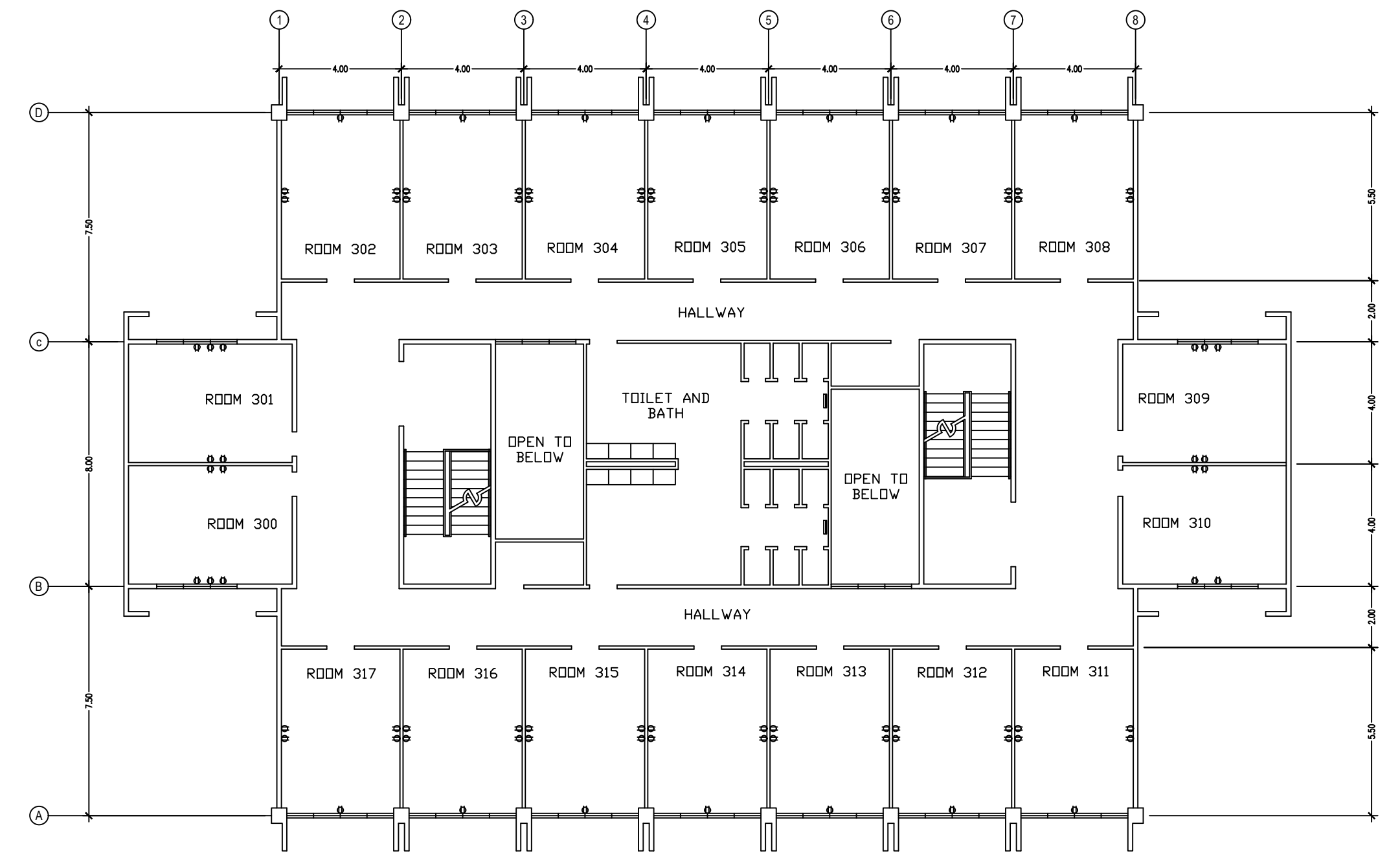

GRHM 2ND FLOOR

1 INSTALLATION OF CONVENIENCE OUTLETS
SCALE



GRHM 3RD FLOOR

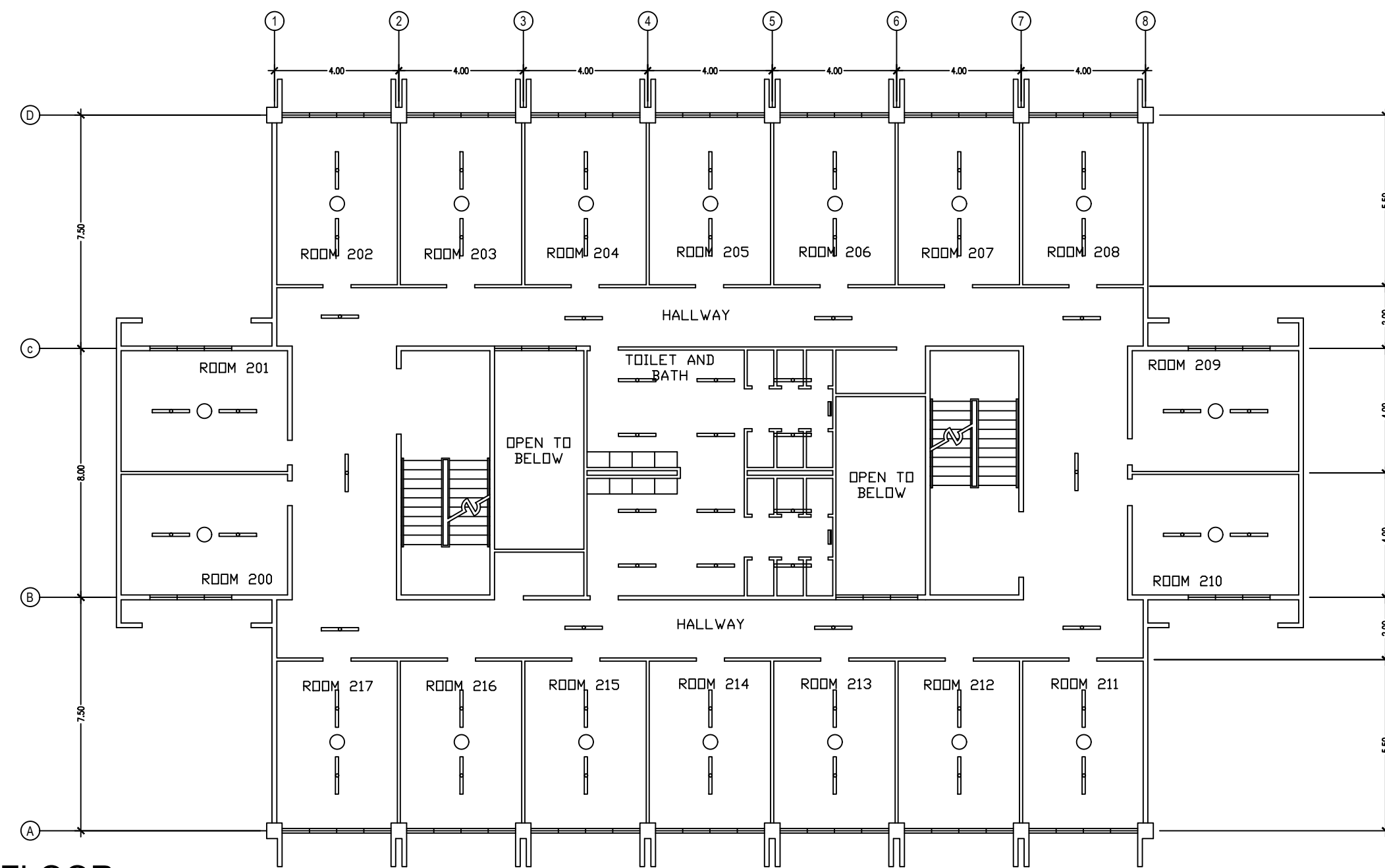

GRHM 2ND FLOOR

2 INSTALLATION OF LIGHT FIXTURES
SCALE



GRHM 3RD FLOOR

FOR BIDDING

PROFESSIONAL		PROJECT/LOCATION		OWNER		APPROVED BY:		REVISION		SHEET CONTENTS		SCALE AS SHOWN		SHEET	
ARCHITECT/ENGINEER		REHABILITATION OF SCHOOL BUILDINGS		Department of Science and Technology PHILIPPINE SCIENCE HIGH SCHOOL MAIN CAMPUS		LAWRENCE V. MADRIAGA, PhD		DATE 20190510		GIRLS' RESIDENCE HALL MAIN BUILDING 2ND & 3RD FLOOR LAYOUT		A		16	
PRC NO.:	PTR:	Agham Road, Diliman, Quezon City				Director, PSHS - MAIN CAMPUS				DRAWN CHECKED		DESIGNED DATE 10MAY2019		27	
VALID UNTIL:		DATE/PLACE:								THESE DRAWINGS ARE INSTRUMENTS OF PROFESSIONAL ARCHITECTURAL SERVICE AND ARE NOT TO BE REPRODUCED OR USED EXCEPT BY WRITTEN AGREEMENT WITH THE ARCHITECT. (R.A. 9266)					