

1 LOCATION PLAN

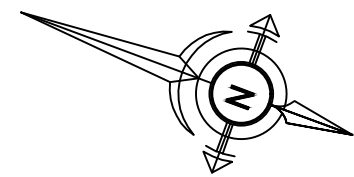

2 SITE DEVELOPMENT PLAN

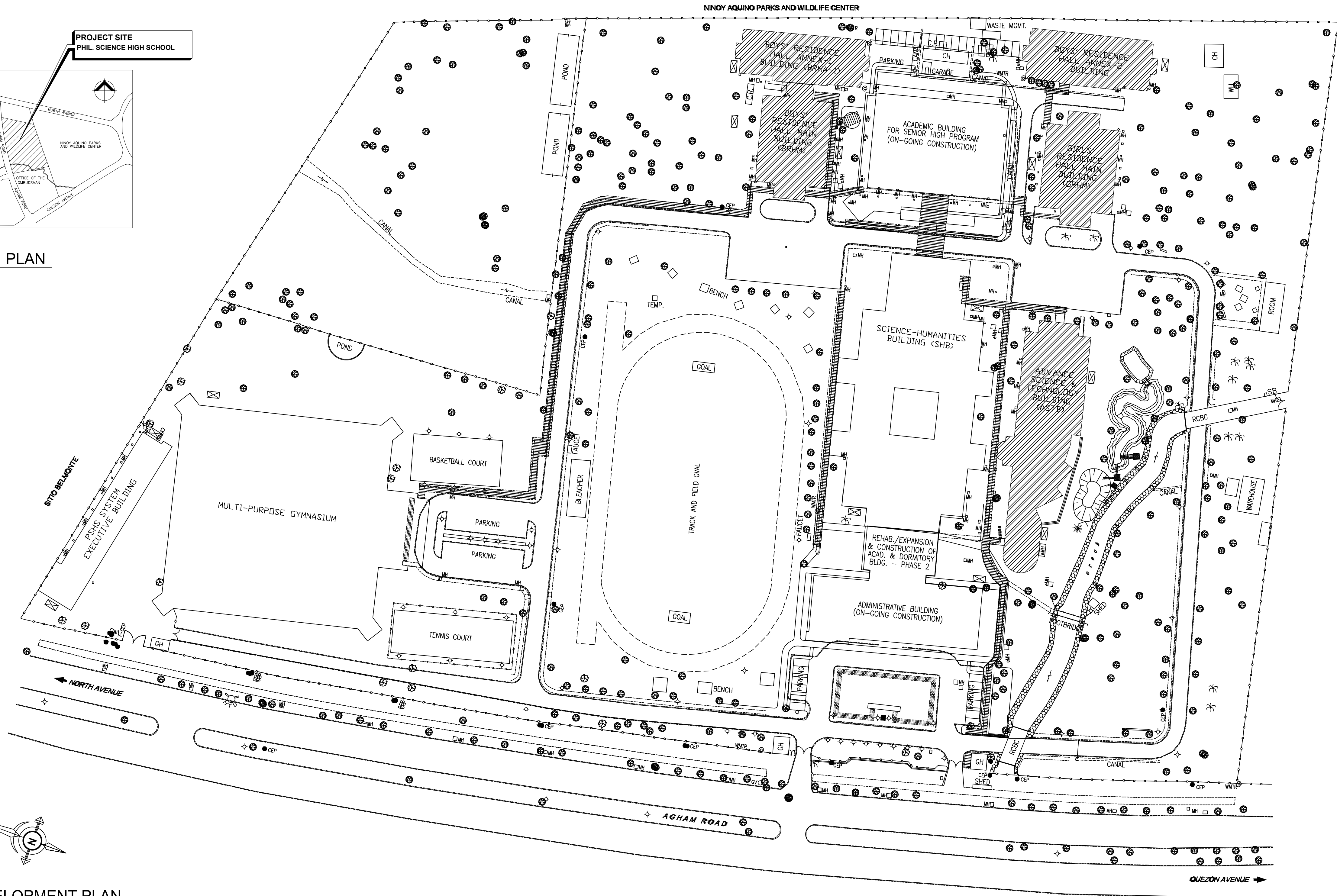
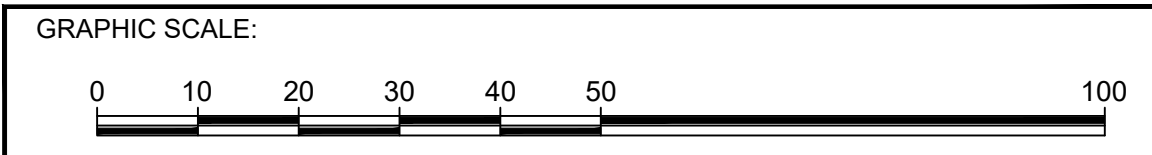

PROFESSIONAL		PROJECT/LOCATION	OWNER	APPROVED BY:	REVISION	SHEET CONTENTS	SCALE 1:750M/S	SHEET
ARCHITECT/ENGINEER		REHABILITATION OF SCHOOL BUILDINGS	Department of Science and Technology PHILIPPINE SCIENCE HIGH SCHOOL MAIN CAMPUS	LAWRENCE V. MADRIAGA, PhD Director, PSHS - MAIN CAMPUS	DATE 20190510	SITE DEVELOPMENT PLAN SHOWING LOCATIONS OF PROJECT COMPONENTS		1
PRC NO.:	PTR:	Agham Road, Diliman, Quezon City				DRAWN	DESIGNED	THESE DRAWINGS ARE INSTRUMENTS OF PROFESSIONAL ARCHITECTURAL SERVICE AND ARE NOT TO BE REPRODUCED OR USED EXCEPT BY WRITTEN AGREEMENT WITH THE ARCHITECT. (R.A. 9266)
VALID UNTIL:	DATE/PLACE:					CHECKED	DATE 10MAY2019	